

RO INSTRUCTIUNI DE ASAMBLARE - **DULAP BAIE DAX 3 USI - 500 x 300 x 1800 MM**

EN ASSEMBLY INSTRUCTIONS - **BATHROOM CABINET DAX 3 DOORS - 500 x 300 x 1800 MM**

RO

NUMAR	LUNGIME	LATIME	BUC	CULOARE
1	500	300	1	CULOARE1
2	500	300	1	CULOARE1
3	1668	300	2	CULOARE1
4	1100	300	1	CULOARE1
5	276	300	2	CULOARE1
6	276	290	2	CULOARE1
7	100	468	1	CULOARE1
8	847	296	2	CULOARE1
9	1696	196	1	CULOARE1
10	534	297	1	PANOU SPATE
11	534	197	1	PANOU SPATE
12	1160	297	1	PANOU SPATE
13	1160	197	1	PANOU SPATE

EN

NUMBER	LENGTH	WIDTH	PCS	COLOR
1	500	300	1	COLOR1
2	500	300	1	COLOR1
3	1668	300	2	COLOR1
4	1100	300	1	COLOR1
5	276	300	2	COLOR1
6	276	290	2	COLOR1
7	100	468	1	COLOR1
8	847	296	2	COLOR1
9	1696	196	1	COLOR1
10	534	297	1	BACK PANNEL
11	534	197	1	BACK PANNEL
12	1160	297	1	BACK PANNEL
13	1160	197	1	BACK PANNEL

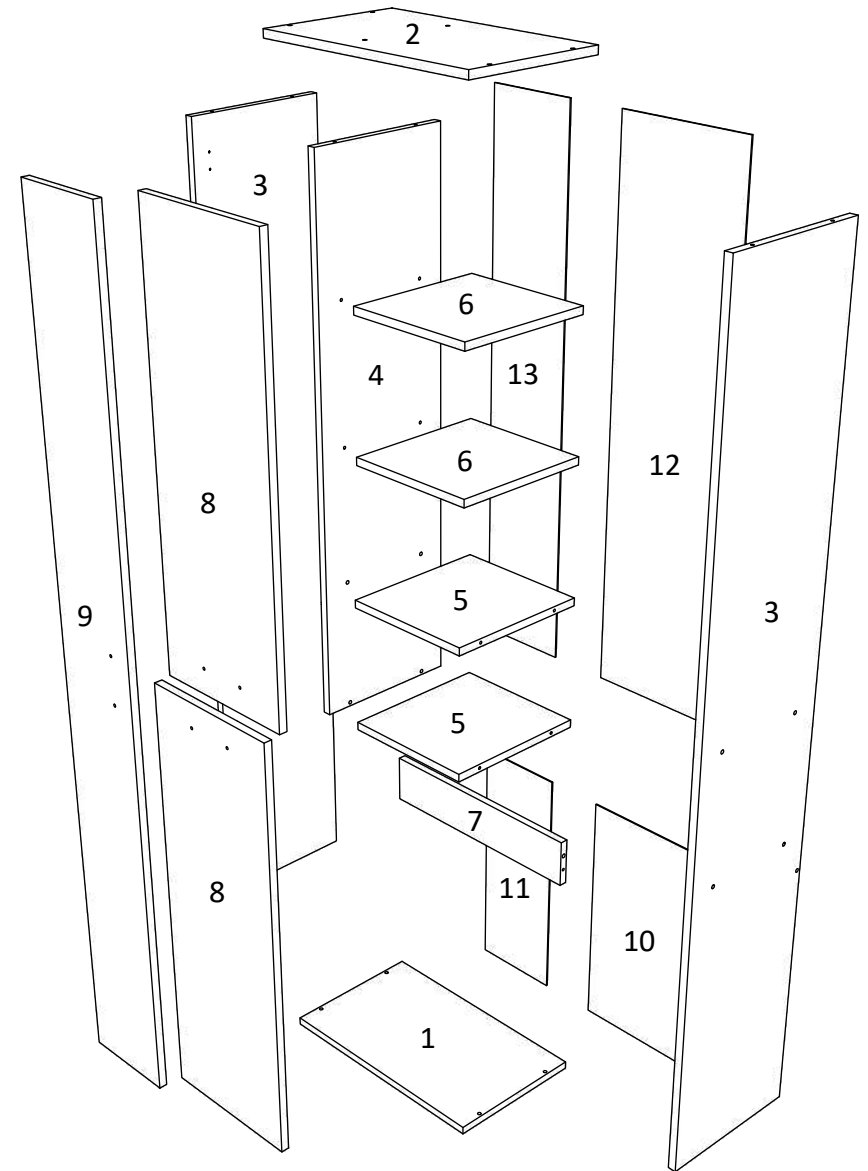
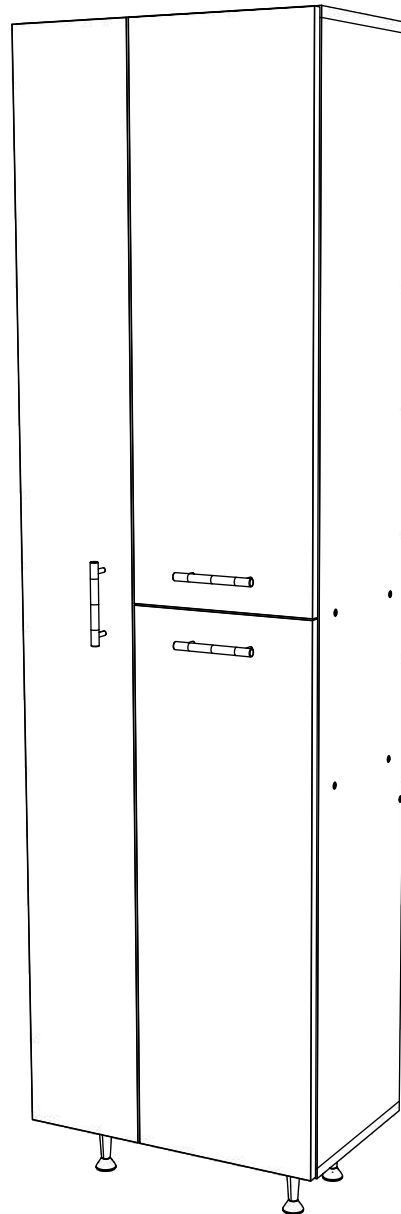

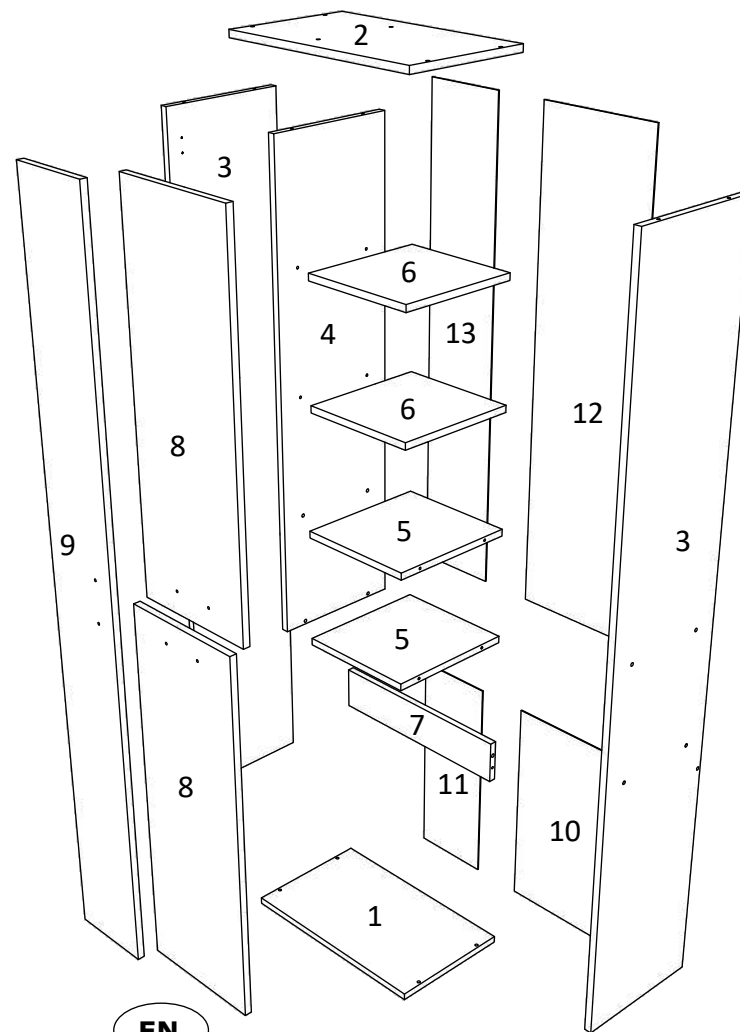
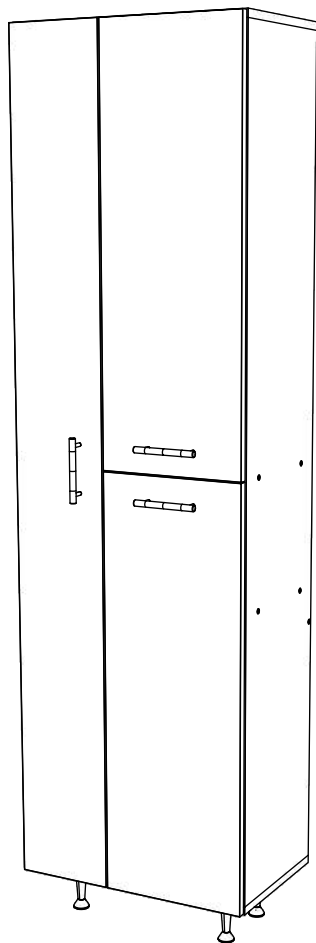

EN

NUMBER	LENGTH	WIDTH	PCS	COLOUR
1	500	300	1	COLOR1
2	500	300	1	COLOR1
3	1668	300	2	COLOR1
4	1100	300	1	COLOR1
5	276	300	2	COLOR1
6	276	290	2	COLOR1
7	100	468	1	COLOR1
8	847	296	2	COLOR1
9	1696	196	1	COLOR1
10	534	297	1	BACK PANNEL
11	534	197	1	BACK PANNEL
12	1160	297	1	BACK PANNEL
13	1160	197	1	BACK PANNEL

A	7x50mm x 20	B	x 18	C	3.5 x 16 mm x 46	D	x 7	E	x 1
F	x 8	G	x 84	H	96 mm x 3	I	M4 x 22 mm x 6	J	x 4
K	1buc L = 466 mm x 1	L	x 2	M	8 mm x 1	O	6x80mm x 1	P	x 1

1

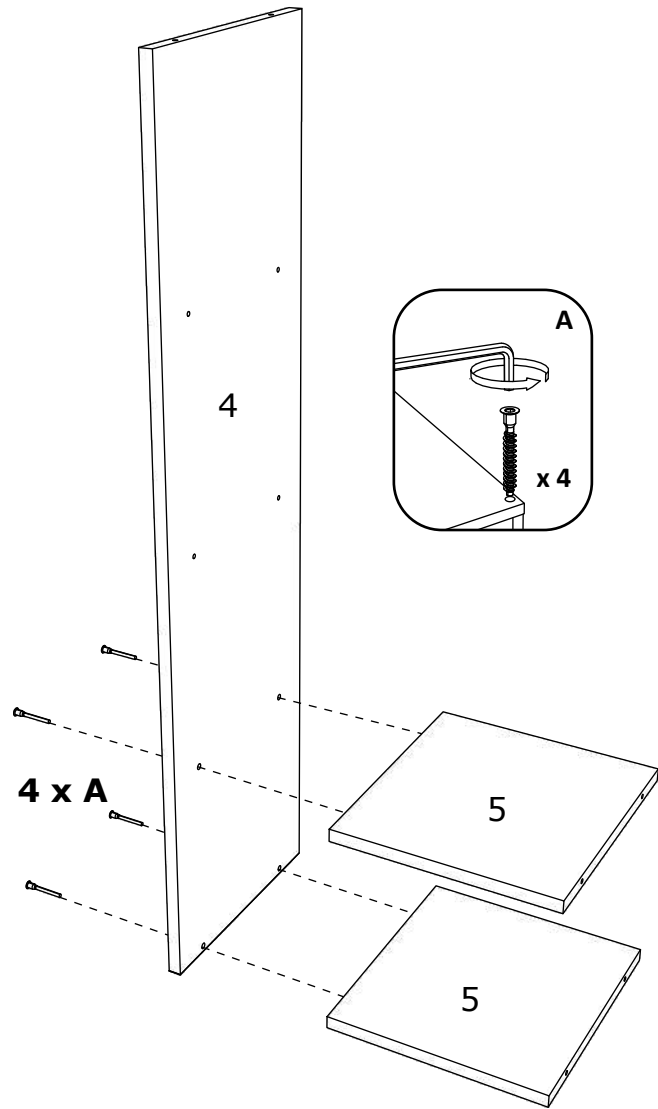

2

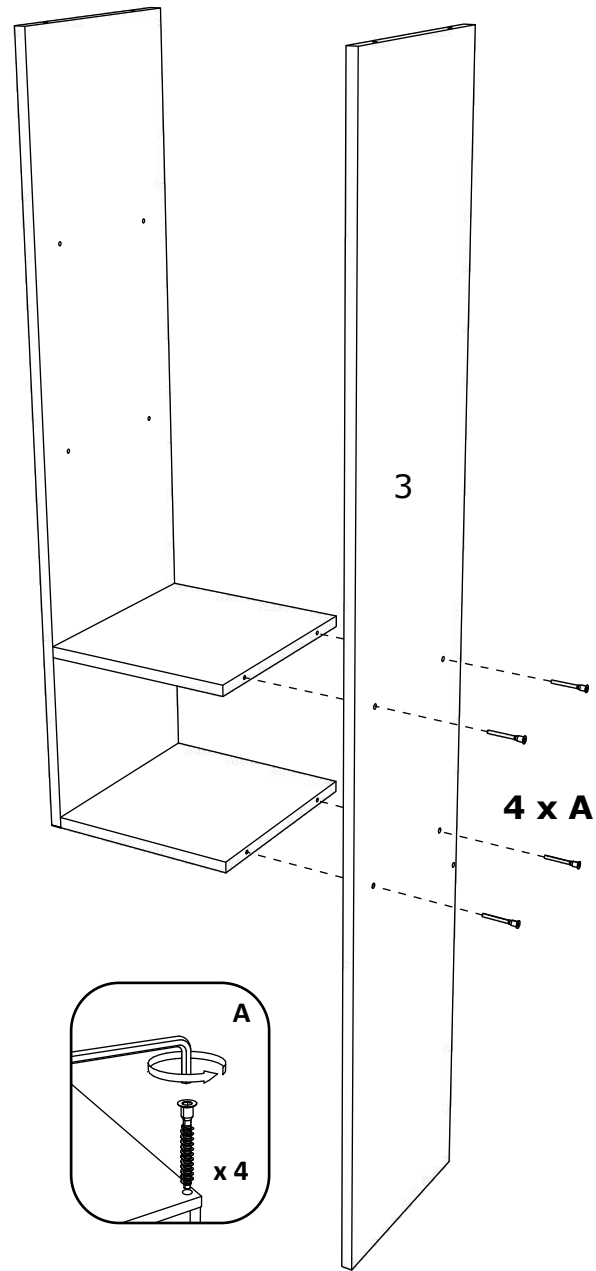

3

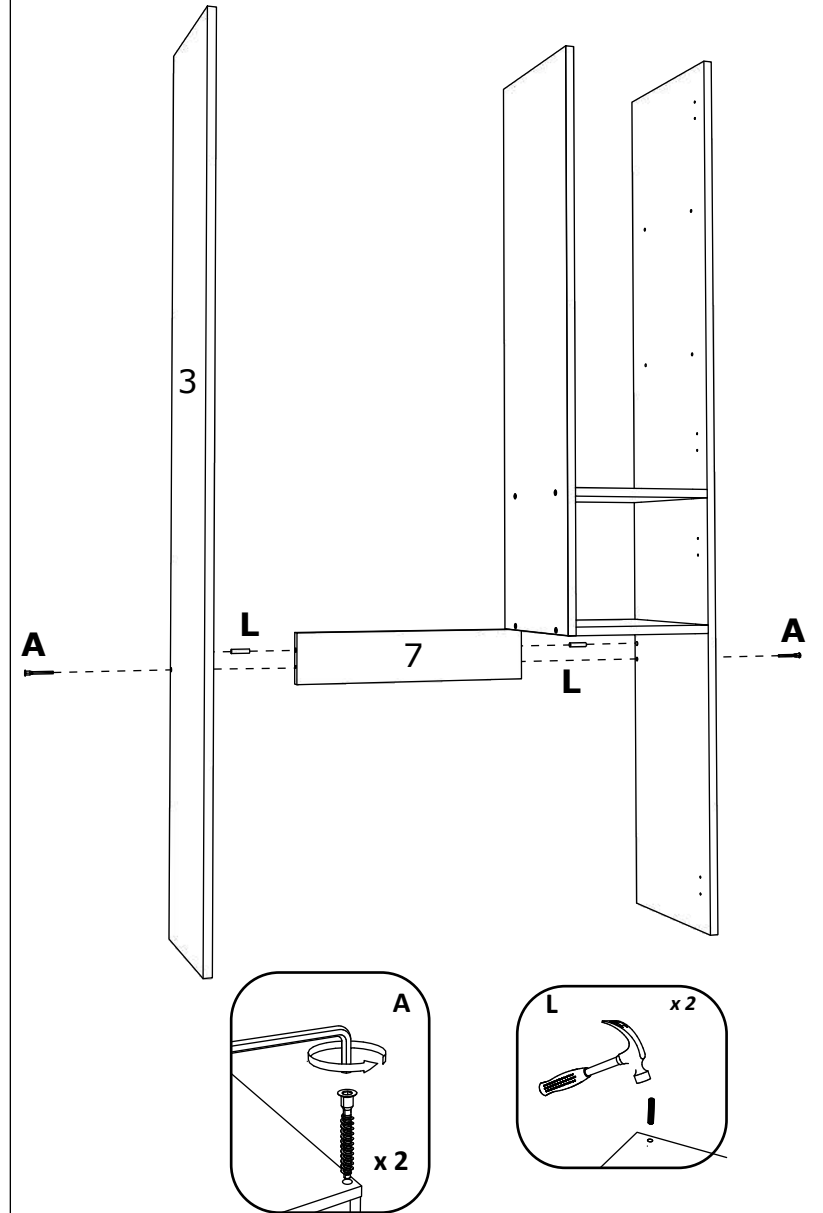

4

6 x A

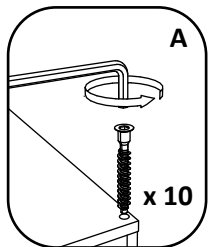
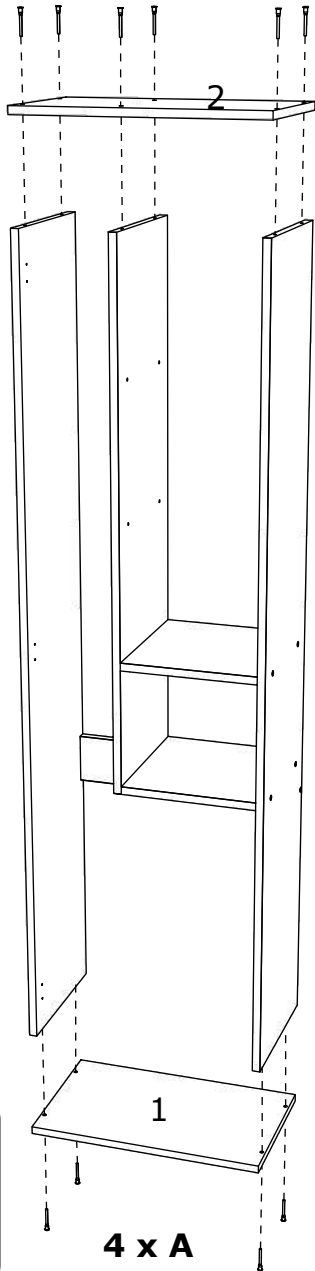

5

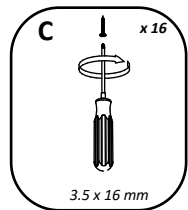
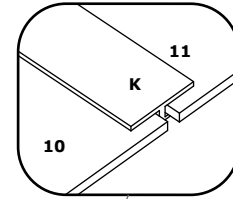
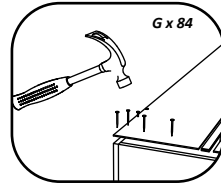
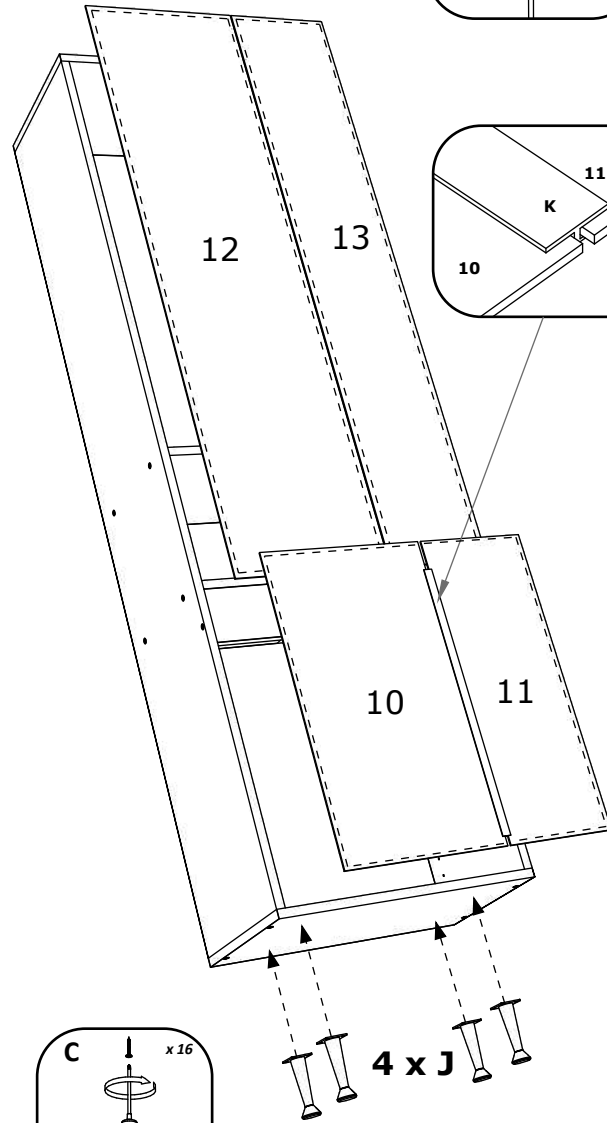

6

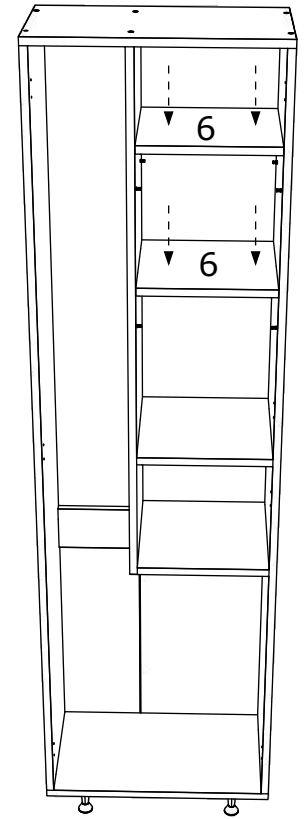
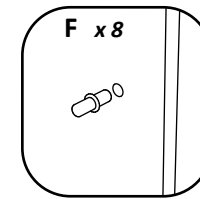
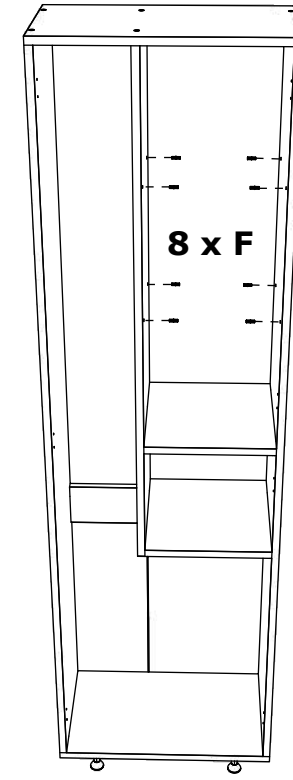

7

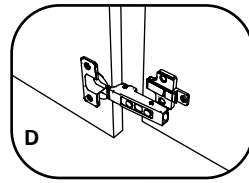
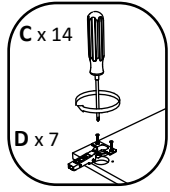
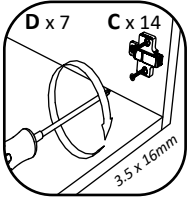
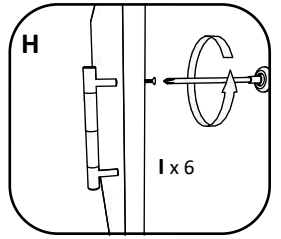
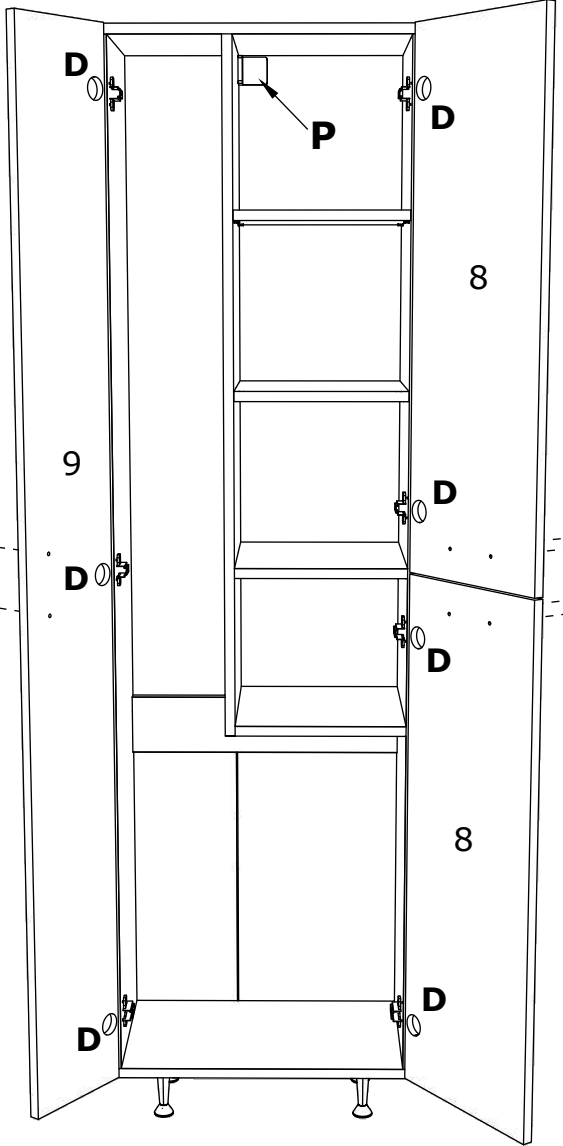
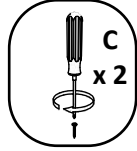
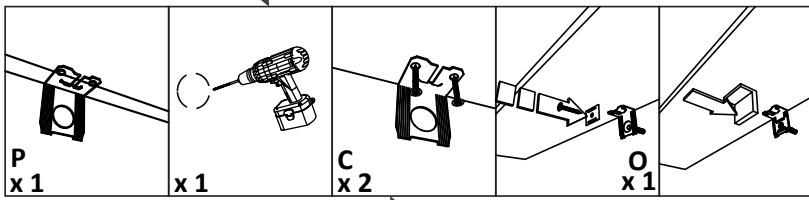

8

